

A large plot of constructible land within walking distance of local amenities.

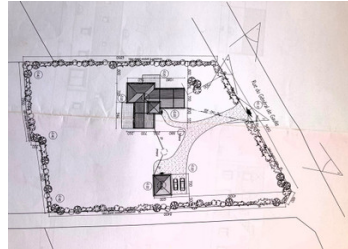

INFORMATION

Town:	Plonévez-du-Faou
Department:	Finistère
Bed:	0
Bath:	0
Floor:	0 m2
Plot Size:	5666 m2

IN BRIEF

This large plot of flat, constructible land, consisting of 3 smaller plots, would be perfect for a large single dwelling or several smaller properties. Situated on the outskirts of a popular village, the land is within walking distance of local amenities. Planning permission had previously been granted for a large family home and the foundations have been laid and construction work started for the walls before the project was put on hold. However, this permission, or permission for smaller properties, would have to be regained as it has now expired. Plans for the property for which planning permission was previously granted are available for clients interested in the land.

ENERGY - DPE

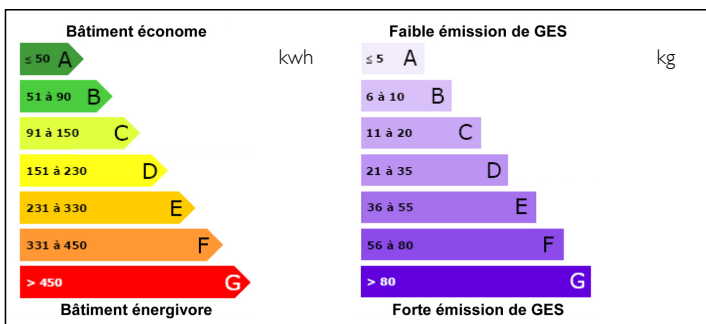

NB. Quoted prices relate to euro transactions. Fluctuations in exchange rates are not the responsibility of the agency or those representing it. The agency and its representatives are not authorised to make or give guarantees relating to the property. These particulars do not form part of any contract but are to be taken as a general representation of the property. Any areas, measurements or distances are approximate. Text, photographs and plans, where applicable, are for guidance only. Leggett and its representatives have not tested services, equipment or facilities and cannot guarantee the same.

Particulars for off-plan purchases are intended as a guide only. Final finishes to the property may vary. Purchasers are advised to engage a solicitor to check the plans and specifications as laid out in their purchase contract with the developer.

DESCRIPTION

Distances (all approximate):

Châteauneuf du Faou - 8.1kms.

Carhaix-Plouguer - 23.2kms.

Roscoff ferry port - 67.2kms.

Brest airport - 69.9kms.

Beach at Plonévez-Porzay - 47.6kms.

Information about risks to which this property is exposed is available on the Géorisques website :
<https://www.georisques.gouv.fr>

NOTES